

[\[EN\] Print Position Adjustment Manual for printer CP-K60DW series \(P.2\)](#)

[\[DE\] Handbuch zur Anpassung der Druckposition für Drucker der Serie CP-K60DW \(P. 4\)](#)

[\[ES\] Manual de ajuste de la posición de impresión para impresora de la serie CP-K60DW \(P. 6\)](#)

[\[FR\] Manuel de réglage de la position d'impression pour les imprimantes de la série CP-K60DW \(P. 8\)](#)

[\[PT\] Manual de ajuste da posição de impressão para impressoras série CP-K60DW \(P. 10\)](#)

[\[IT\] Manuale di regolazione della posizione di stampa per la stampante serie CP-K60DW \(P.12\)](#)

[\[CN\] CP-K60DW 系列打印机打印位置调整手册 \(P.14\)](#)

[EN] Print Position Adjustment Manual for printer CP-K60DW series

version 1.00

This application can be used for CP-K60DW series.

[Overview]

This application enables you to adjust the vertical Print Position when you find the margin at the top and bottom of the print.

<OS>

1. Windows 7 32bit/64bit version
2. Windows 10 32bit/64bit version
3. Windows 11 64bit version

<Installation>

Copy the folder containing 'ADJK60POSI_Ver100.exe' into your PC anywhere.

<Operation>

1. Turn on your printer and set the ink and paper to use.
2. Start 'ADJK60POSI_Ver100.exe' by 'Run as administrator'.
3. Click 'Print' to print adjustment pattern.

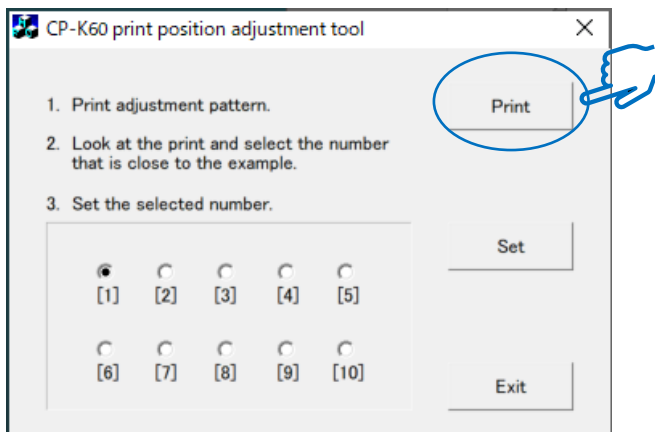

4. Look at the print of adjustment pattern and select the number (1 to 10) that best matches top and bottom edges compared to **Good** example.

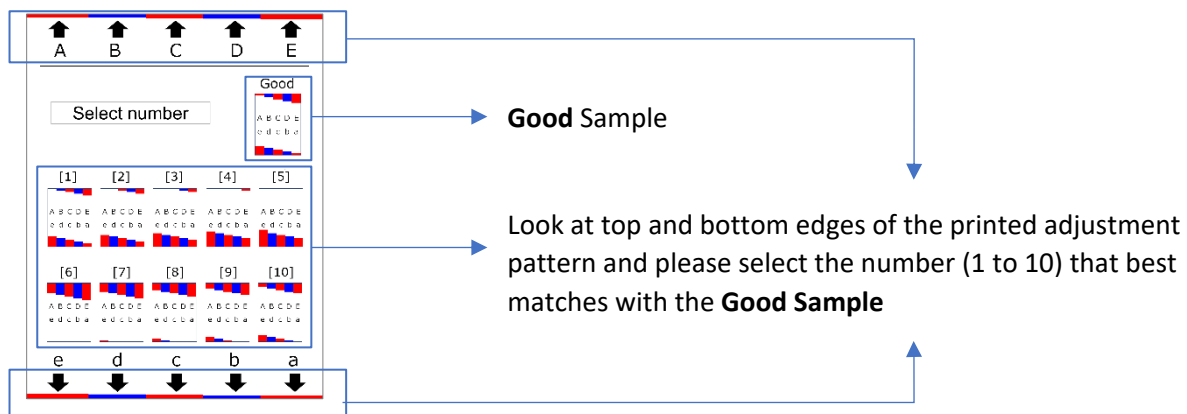

5. Press the button with the selected number and click "Set". The printer adjustment value will be updated, and it will be restarted automatically.

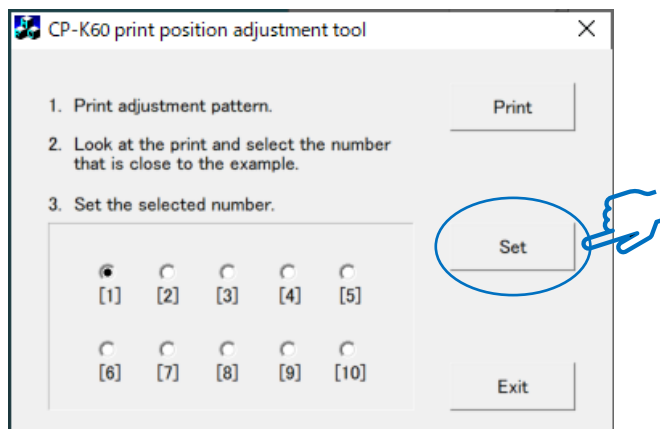

6. Click "Print" to print the adjustment pattern and check the print. If it is not good, please repeat from item 4.

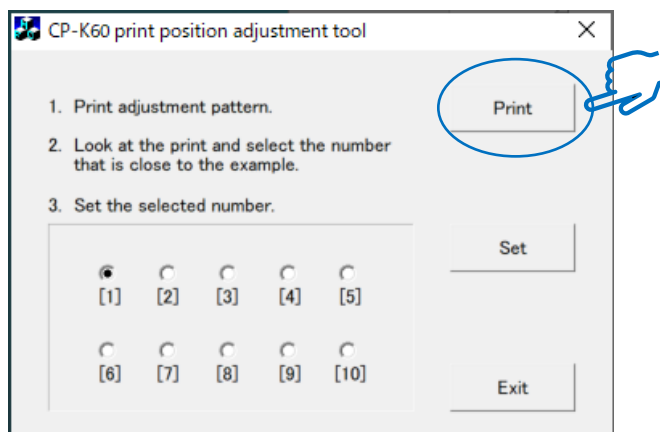

7. If the print becomes good, click "Exit" to finish.

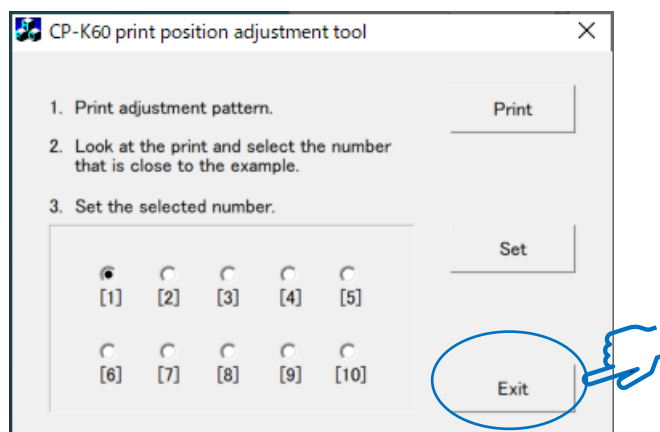

8. Print any image with your printing tool and confirm to improve of the margin.

Note: If the print does not become good after repeated adjustment, please contact to your distributor or regional Technical Support.

Windows 7, Windows10 and Windows11 are either registered trademarks or trademarks of Microsoft Corporation in the U.S.A. and/or other regions and/or countries.

[DE] Handbuch zur Anpassung der Druckposition für Drucker der Serie CP-K60DW

Version 1.00

Diese Anwendung kann für die CP-K60DW-Serie verwendet werden.

[Überblick]

Mit dieser Anwendung können Sie die vertikale Druckposition anpassen, wenn am oberen und unteren Rand des Ausdrucks ein Rand festgestellt wird.

<Betriebssystem>

1. Windows 7 32bit/64bit version
2. Windows 10 32bit/64bit version
3. Windows 11 64bit version

<Installation>

Kopieren Sie den darin enthaltenen Ordner „ADJK60POSI_Ver100.exe“ irgendwo auf Ihren PC.

<Betrieb>

1. Schalten Sie Ihren Drucker ein und stellen Sie die zu verwendende Ribbon und das zu verwendende Papier ein.
2. Starten Sie „ADJK60POSI_Ver100.exe“ über „Als Administrator ausführen“.
3. Klicken Sie auf „Print“, um das Anpassungsmuster zu drucken.

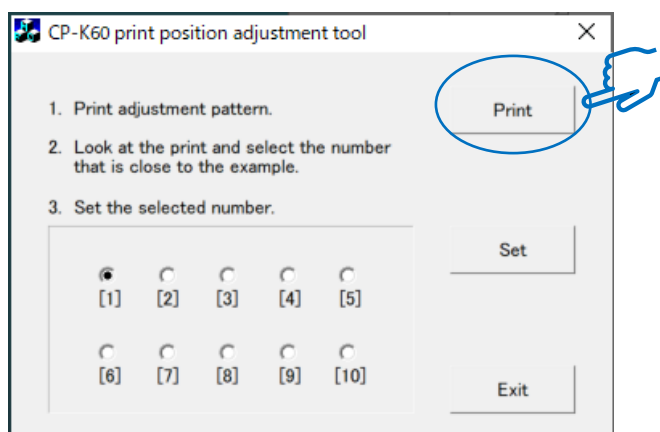

4. Sehen Sie sich den Ausdruck an und wählen Sie die Zahl (1 bis 10) aus, bei der die Ober- und Unterkante dem Beispiel nahe kommen.

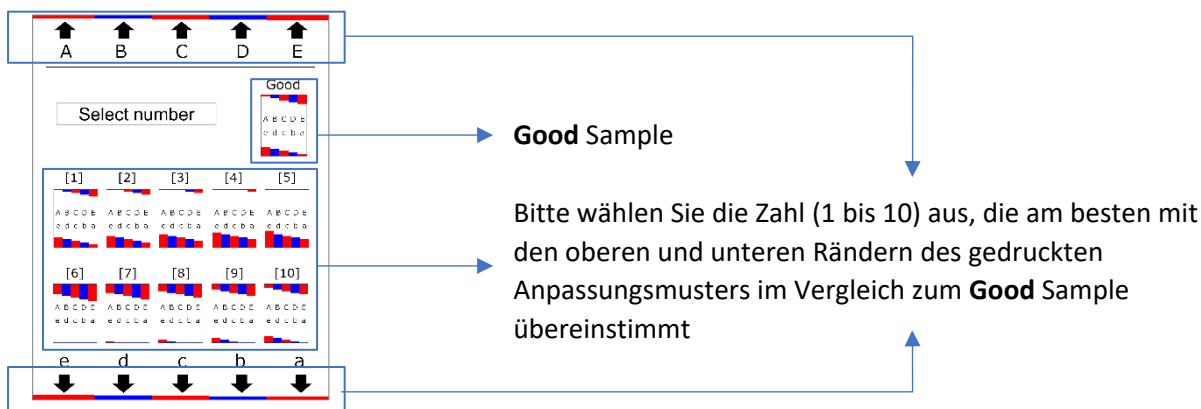

5. Drücken Sie die Schaltfläche mit der ausgewählten Nummer und klicken Sie auf „Set“. Der Druckeranpassungswert wird aktualisiert und automatisch neu gestartet.

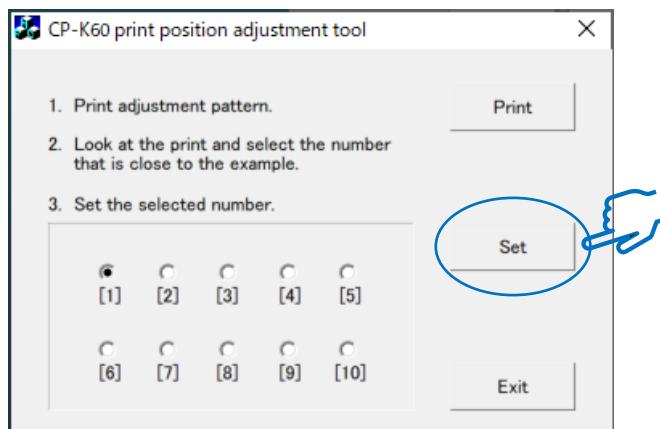

6. Klicken Sie auf „Print“, um das Anpassungsmuster zu drucken und den Druck zu überprüfen. Wenn es nicht gut ist, wiederholen Sie bitte ab Punkt 4.

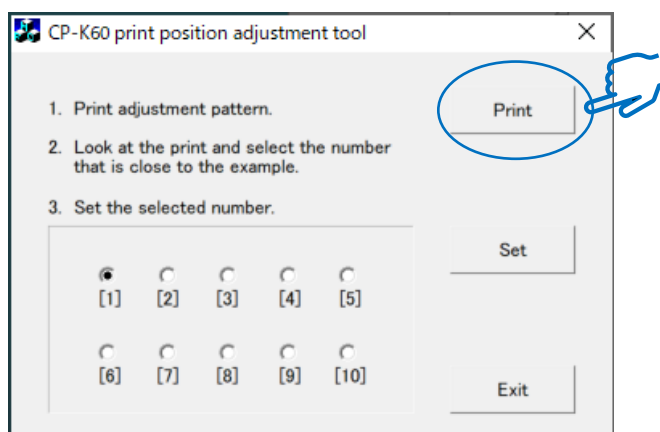

7. Wenn der Druck gut wird, klicken Sie auf „Exit“ um zu Beenden.

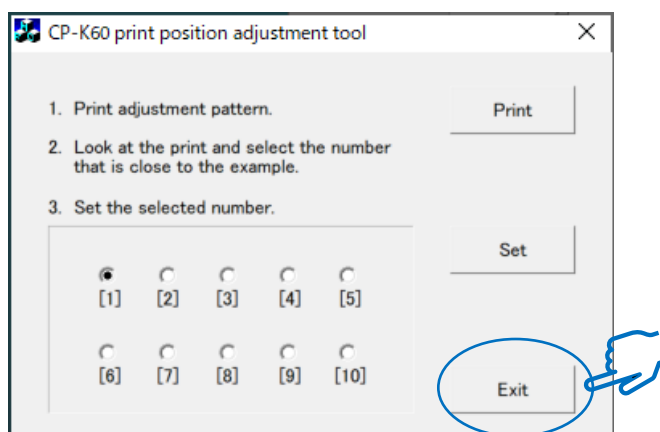

8. Drucken Sie ein beliebiges Bild mit Ihrem Druckwerkzeug und bestätigen Sie, um den Rand zu verbessern.

Hinweis: Wenn der Rand nicht entfernt wird, wenden Sie sich an Ihren örtlichen Händler.

Windows 7, Windows10 und Windows11 sind entweder eingetragene Warenzeichen oder Warenzeichen der Microsoft Corporation in den USA und/oder anderen Regionen und/oder Ländern.

[ES] Manual de ajuste de la posición de impresión para la impresora CP-K60DW

versión 1.00

Esta aplicación se puede utilizar para las impresoras de la serie CP-K60DW.

[Visión general]]

Esta aplicación le permite ajustar la posición de impresión vertical cuando se detecta un margen en la parte superior y/o inferior de la impresión.

<SO>

1. Versión de Windows 7 de 32 bit/64 bit
2. Versión de Windows 10 de 32 bit/64 bit
3. Versión de Windows 11 de 64 bit

<Instalación>

Copie la carpeta que contiene 'ADJK60POSI_Ver100.exe' en cualquier lugar de su PC.

<Operación>

1. Encienda su impresora y cargue la tinta y el papel a utilizar.
2. Inicie 'ADJK60POSI_Ver100.exe' mediante 'Ejecutar como administrador'.
3. Haga clic en 'Print' para imprimir el patrón de ajuste.

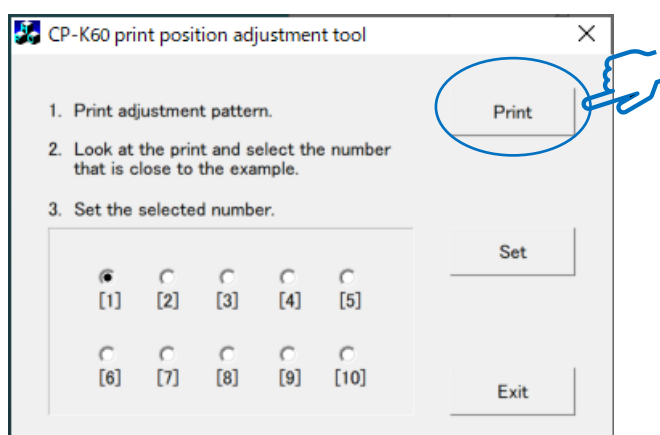

4. Revise los bordes superior e inferior y seleccione el número (1 a 10) que mejor se ajuste al ejemplo.

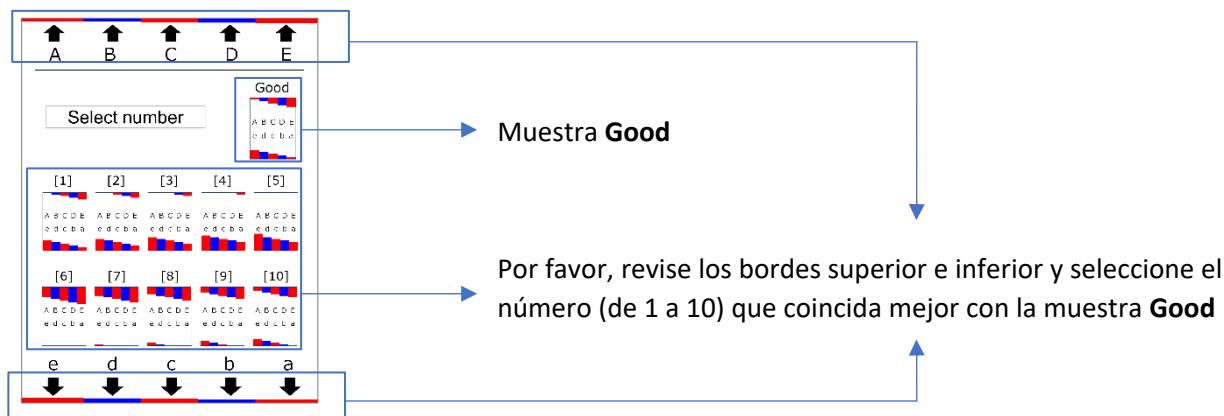

5. Una vez seleccionado el número más adecuado, pulse "Set". El valor de ajuste de la impresora se actualizará y se reiniciará automáticamente.

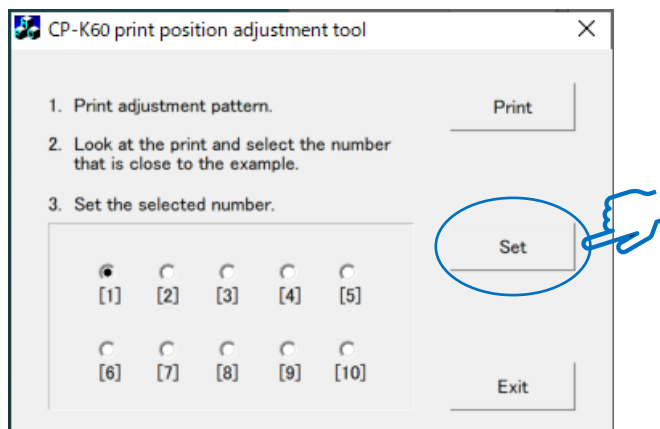

6. Imprima un nuevo patrón de ajuste pulsando "Print", verifique la impresión, si aún no es correcto repita el ajuste desde el punto 4.

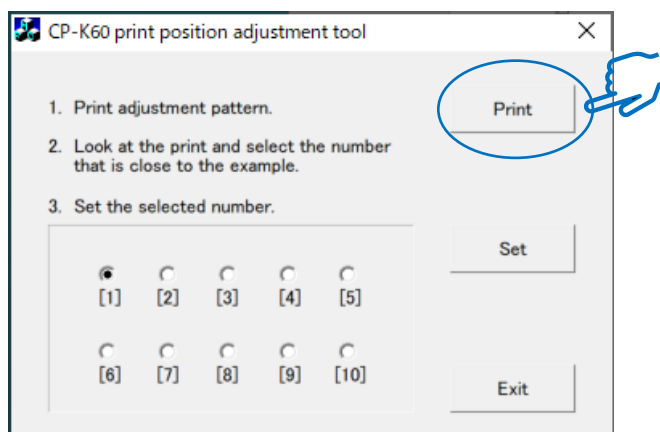

7. Si la impresión es buena, haga clic en "Exit" para finalizar.

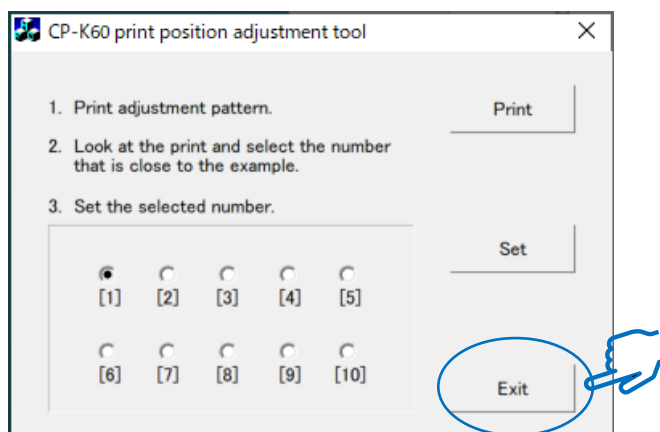

8. Imprima cualquier imagen desde su software de impresión para confirmar que la imagen se ha impreso correctamente.

Nota: Si no se corrige después de varios intentos, contacte con su Distribuidor local.

Windows 7, Windows10 y Windows11 son marcas comerciales registradas o marcas comerciales de Microsoft Corporation en EE. UU. y/u otras regiones y/o países.

[FR] Manuel de réglage de la position d'impression pour les imprimantes de la série CP-K60DW

version 1.00

Cette application peut être utilisée pour la série CP-K60DW.

[Aperçu]

Cette application vous permet d'ajuster la position d'impression verticale lorsque vous trouvez la marge en haut et en bas de l'impression.

<SE>

1. Windows 7 32bit/64bit version
2. Windows 10 32bit/64bit version
3. Windows 11 64bit version

<Installation>

Copiez le dossier contenu 'ADJK60POSI_Ver100.exe' dans votre PC n'importe où.

<Opération>

1. Allumez votre imprimante et mettez le ruban et le papier à utiliser.
2. Démarrez 'ADJK60POSI_Ver100.exe' par 'Exécuter en tant qu'administrateur'.
3. Cliquez sur "Print" pour imprimer le motif de réglage.

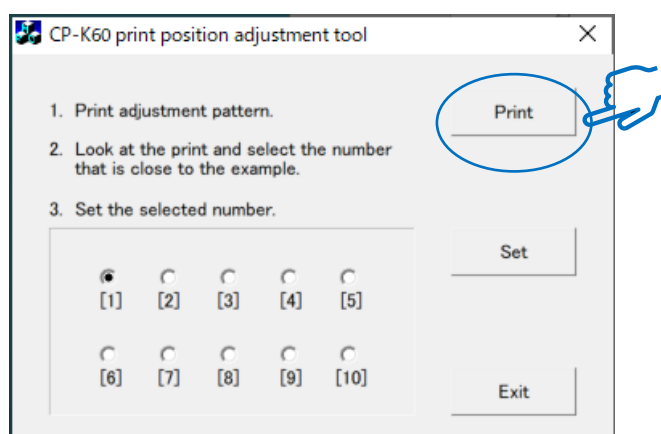

4. Regardez l'impression, vérifiez les bordures supérieure et inférieure et sélectionnez le chiffre (1 à 10) qui correspond le mieux à l'exemple.

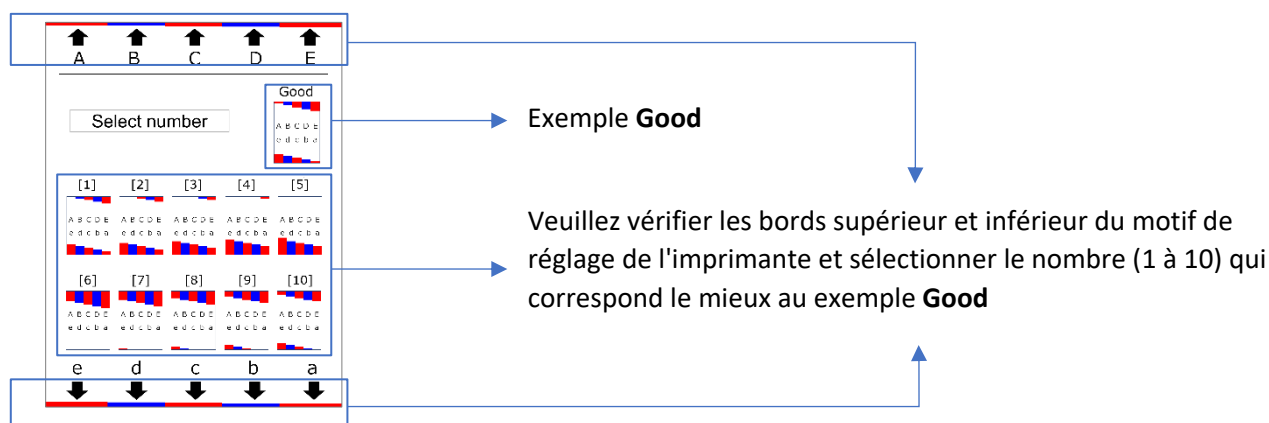

5. Marquez le numéro sélectionné et cliquez sur "Set". La valeur de réglage de l'imprimante sera mise à jour et elle redémarrera automatiquement.

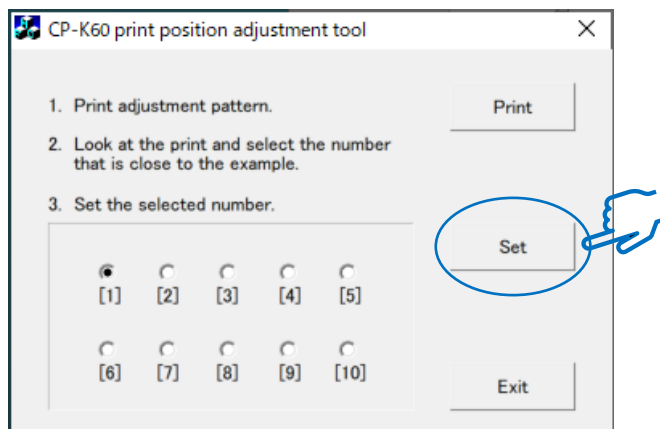

6. Cliquez sur "Print" pour imprimer le motif de réglage et vérifier l'impression. Si ce n'est pas bon, veuillez répéter à partir du point 4.

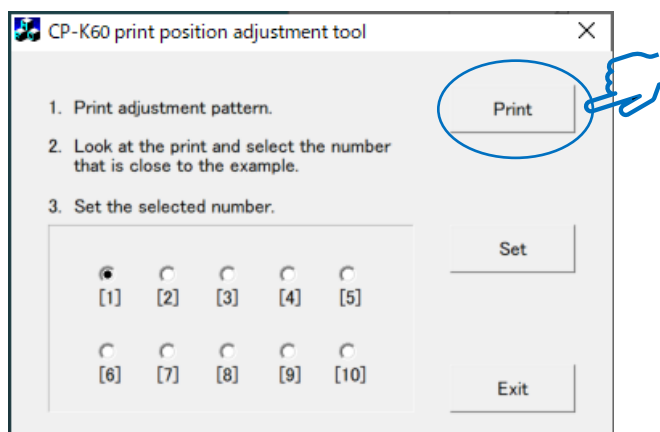

7. Si l'impression devient bonne, cliquez sur "Exit" pour termine.

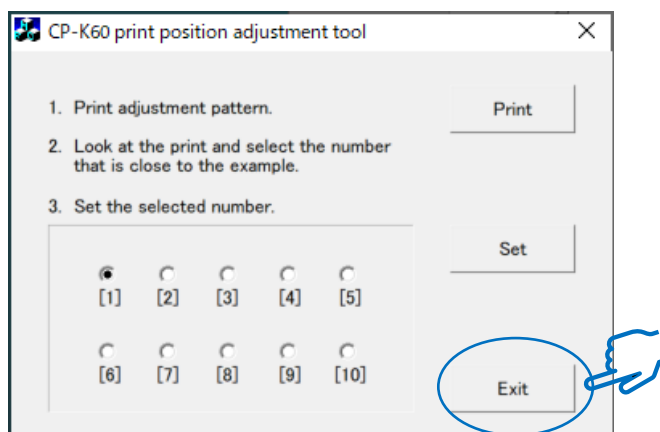

8. Imprimez n'importe quelle image avec votre outil d'impression et confirmez pour améliorer la marge.

Remarque : si cela ne fonctionne pas, veuillez consulter votre distributeur local.

Windows 7, Windows10 et Windows11 sont des marques déposées ou des marques commerciales de Microsoft Corporation aux États-Unis et/ou dans d'autres régions et/ou pays.

[PT] Manual de ajuste da posição de impressão para impressoras da série CP-K60DW

versão 1.00

Esta aplicação pode ser usada para a série CP-K60DW.

[Visão geral]

Esta aplicação permite ajustar a posição de impressão vertical quando encontrar uma margem na parte superior e inferior nas impressões..

<SO>

1. Versão do Windows 7 de 32 bit/64 bit
2. Versão do Windows 10 de 32 bit/64 bit
3. Versão do Windows 11 de 64 bit

<Instalação>

Copie a pasta que contem o 'ADJK60POSI_Ver100.exe' e guarde no seu PC em qualquer lugar

<Operação>

1. Ligue a impressora e defina a tinta e o papel a serem usados.
2. Inicie 'ADJK60POSI_Ver100.exe', sendo que deve 'Executar como administrador'.
3. Clique em "Print" para imprimir o modelo padrão

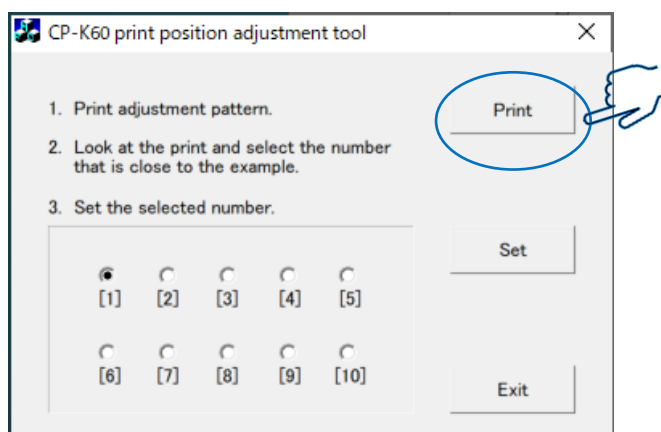

4. Observe a impressão, e verifique as margens e selecione o número de (1 a 10) que se aproximar mais da amostra. .

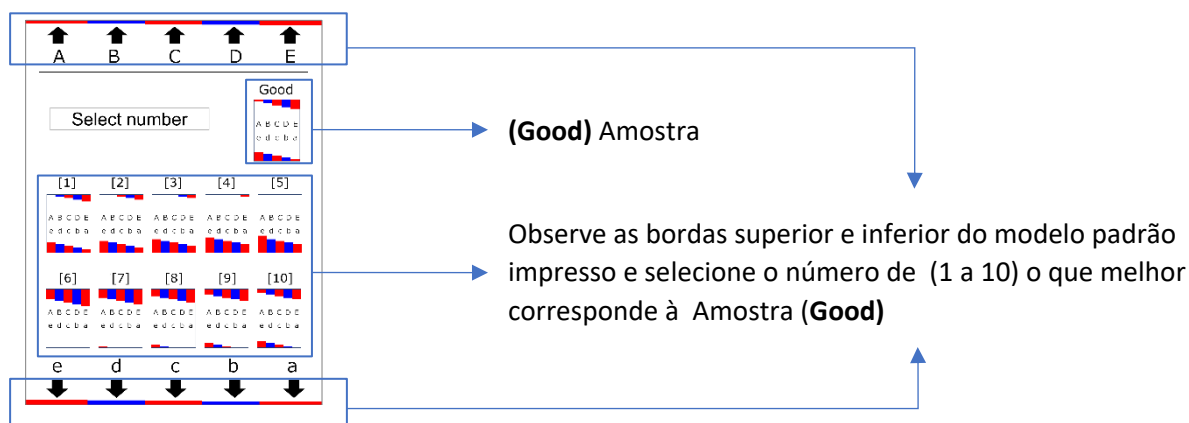

5. Pressione o botão com o número selecionado e clique em "Set". O valor de ajuste da impressora será atualizado e será reiniciado automaticamente.

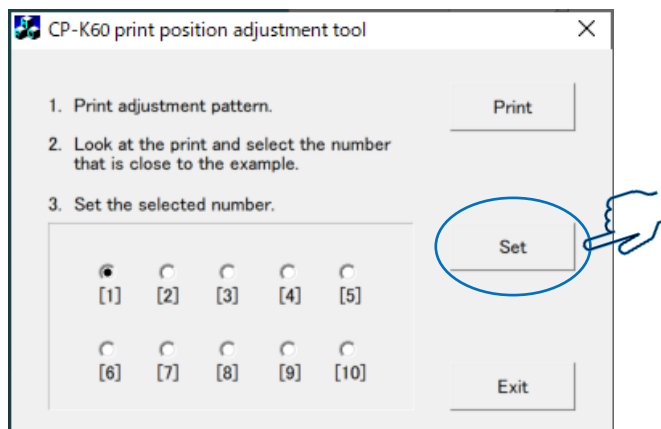

6. Clique em "Print" para imprimir o modelo padrão e verifique a impressão. Se não estiver correta, repita o procedimento a partir do passo nº 4.

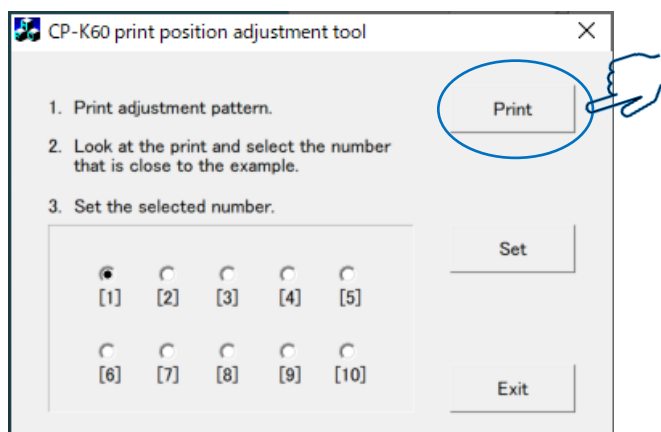

7. Se a impressão ficar boa, clique em "Exit" para finalizar.

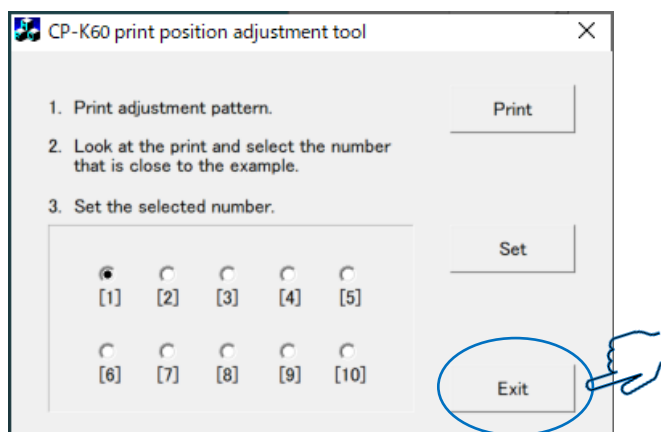

8. Imprima qualquer imagem com a sua ferramenta de impressão e confirme que a margem melhorou.

Nota: Se não obtiver sucesso após diversas tentativas, consulte o seu distribuidor local

Windows 7, Windows10 e Windows11 são marcas registradas ou marcas comerciais da Microsoft Corporation nos EUA e/ou em outras regiões e/ou países.

[IT] Manuale di regolazione della posizione di stampa per la stampante serie CP-K60DW

versione 1.00

Questa applicazione può essere utilizzata per la serie CP-K60DW.

[Panoramica]

Questa applicazione consente di regolare la posizione di stampa verticale quando si trova il margine nella parte superiore e inferiore della stampa.

<OS>

1. Versione di Windows 7 a 32 bit/64 bit
2. Versione di Windows 10 a 32 bit/64 bit
3. Versione di Windows 11 a 64 bit

<Installazione>

Copia la cartella contenuta 'ADJK60POSI_Ver100.exe' nel tuo PC ovunque.

<Operazione>

1. Accendere la stampante e impostare l'inchiostro e la carta da utilizzare.
2. Avvia 'ADJK60POSI_Ver100.exe' da 'Esegui come amministratore'.
3. Fare clic su "Print" per stampare il motivo di regolazione.

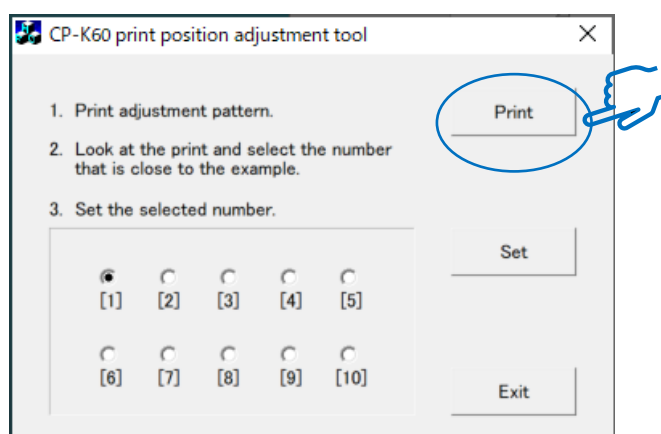

4. Guarda la stampa e seleziona il numero (da 1 a 10) il bordo superiore e inferiore siano vicini all'esempio.



5. Premere il pulsante con il numero selezionato e fare clic su "Set". Il valore di regolazione della stampante verrà aggiornato e verrà riavviato automaticamente.

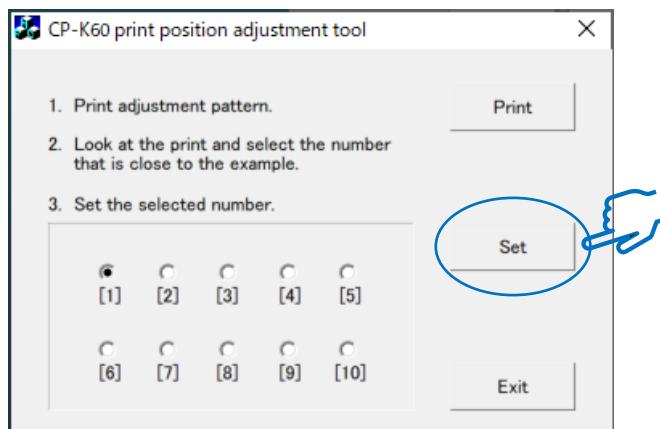

6. Fare clic su "Print" per stampare il motivo di regolazione e controllare la stampa. Se non va bene, ripetere dal punto 4.

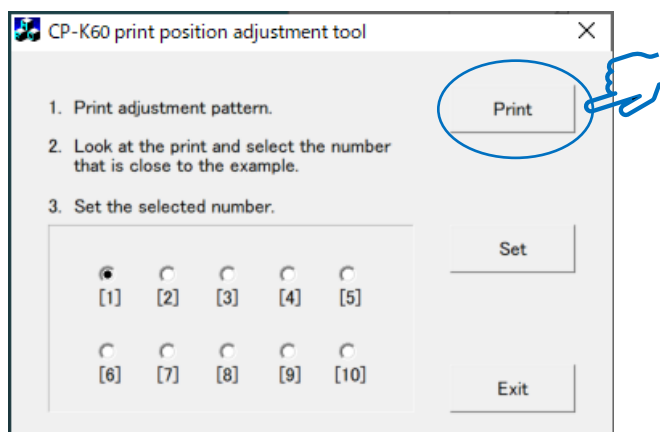

7. Se la stampa diventa buona, fare clic su "Exit" per terminare.

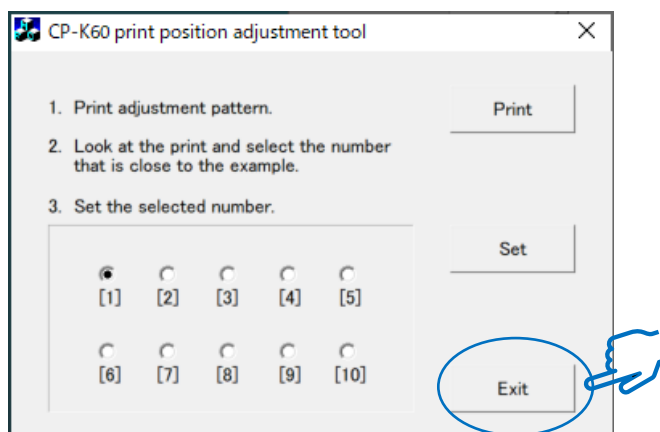

8. Stampare delle immagine con il tuo software di stampa e conferma per migliorare il margine.

Nota Se dopo diversi tentativi continua a non funzionare, consulta il tuo distributore locale.

Windows 7, Windows10 e Windows11 sono marchi registrati o marchi di fabbrica di Microsoft Corporation negli Stati Uniti e/o in altre regioni e/o paesi.

[CN] CP-K60DW 系列打印机打印位置调整手册

版本 1.00

此应用程序可用于 CP-K60DW 系列。

[概述]

当您在打印件的顶部和底部发现空白时，此应用程序可让您调整垂直打印位置。

<操作系统>

1. Windows 7 32bit/64bit 版本
2. Windows 10 32bit/64bit 版本
3. Windows 11 64bit 版本

<安装>

将包含“ADJK60POSI_Ver100.exe”的文件夹复制到您的 PC 中的任何位置。

<操作>

1. 打开打印机并设置要使用的色带和纸张。
2. 通过“以管理员身份运行”启动“ADJK60POSI_Ver100.exe”。
3. 点击“Print”打印调整图案。

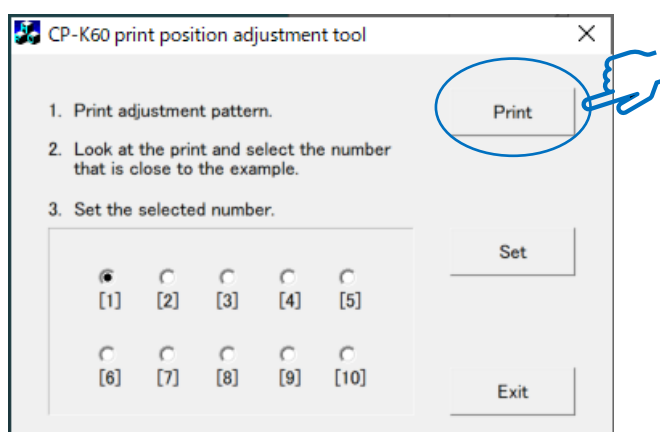

4. 查看打印结果并选择顶部和底部边缘接近示例的数字（1 到 10）。

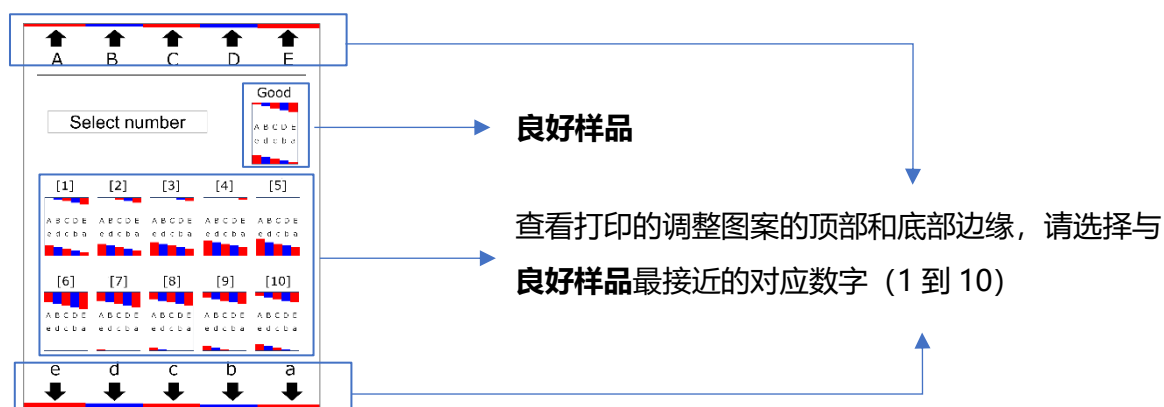

5. 点击选择数字的按钮，然后单击“Set”。打印机调整值将更新，并自动重新启动。

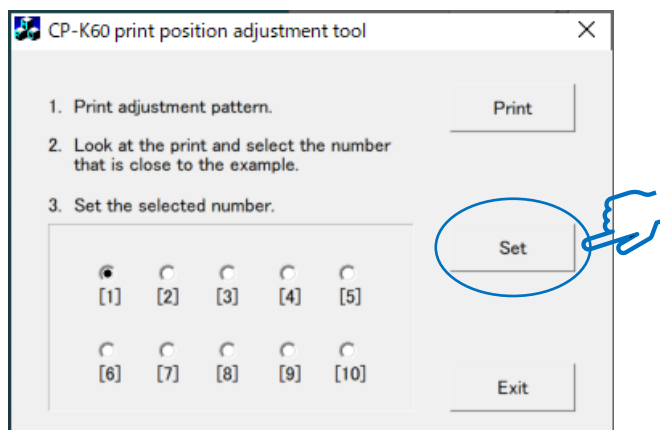

6. 点击“Print”打印调整图案并检查打印结果。如果仍然不够好，请从第 4 项开始重复。

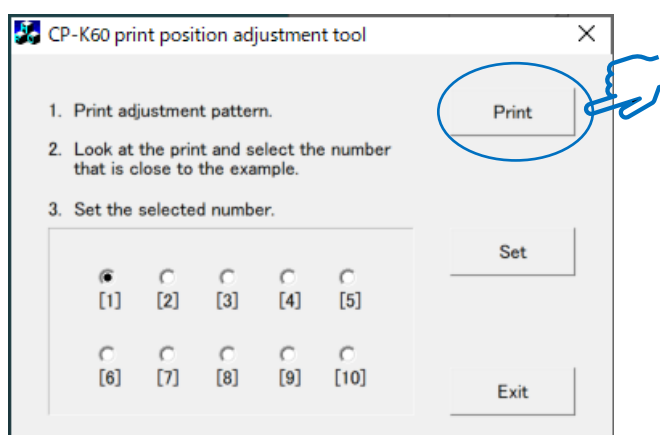

7. 如果打印结果满意，点击“Exit”完成。

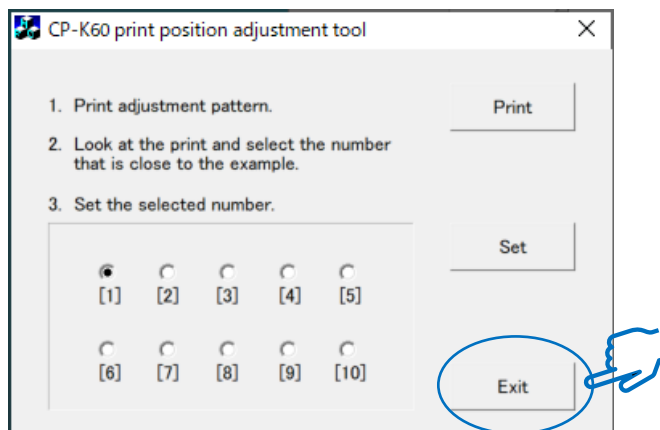

8. 使用您的打印工具打印任何图像，确认边缘得到改善。

注意：如果多次没有得到改善，请咨询您购买的商店。

Windows 7、Windows10 和 Windows11 是 Microsoft Corporation 在美国和/或其他地区和/或国家的注册商标或商标。